

Ex9IP

Ex9B

Ex9B

-
-

ON/OFF /

1000VDC

IEC/EN 60947-3 GB 14048.3

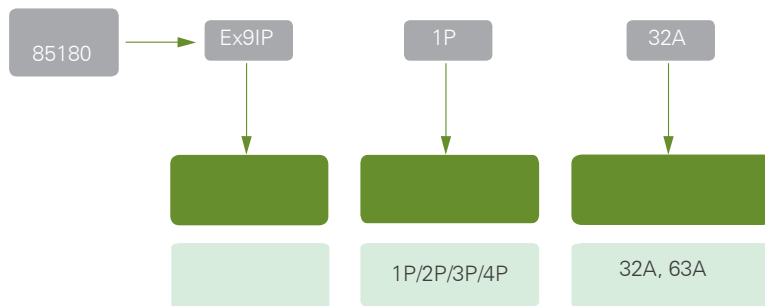

SD Ex9IP

Ex9IP

(IEC/EN 60947-3 / GB 14048.3)



1P

2P

3P

4P

		250	500	750	1000	
U _e	VDC					
I _n	A	32 63				
U _i	V	1000				
I _e 1s		12				
I _e 0.1s		20				
O~C		10000				
		1700				
		1000				
		300				
		IP40				
		IP20				
		DC-22B				
	mm	1~35				
		-30~+70				
		2				
		≤2000				
		+20	95%	+40	50%	
		3				
		III				
		TH35-7.5/DIN35				
x x (mm)		a	18	36	54	72
		b	89			
		c	80			
	kg	0.12	0.24	0.36	0.48	



mm	A	V DC		
18	32	250	85180	Ex9IP 1P 32A
18	63	250	85181	Ex9IP 1P 63A
36	32	500	85182	Ex9IP 2P 32A
36	63	500	85183	Ex9IP 2P 63A
54	32	750	85184	Ex9IP 3P 32A
54	63	750	85185	Ex9IP 3P 63A
72	32	1000	85186	Ex9IP 4P 32A
72	63	1000	85187	Ex9IP 4P 63A

Ex9IP光伏隔离开关 Ex9IP Series DC Switch Disconnecter

1

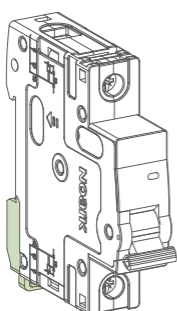

未按本说明书要求操作造成的不良后果，制造商将不承担责任。
The manufacturer assumes no responsibility for unfavourable consequence resulting from the non-application or incorrect application of the instructions provided herein.

NOARK 诺雅克

Ex9IP光伏隔离开关 Ex9IP Series DC Switch Disconnecter

外形尺寸 Dimension

mm

2

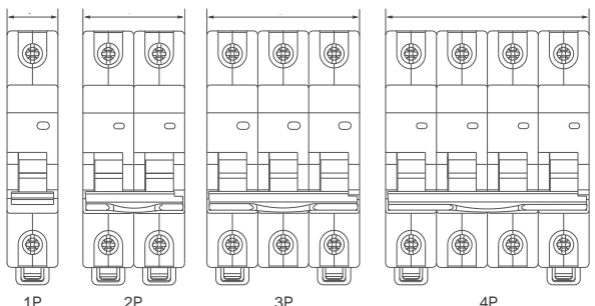

1P

2P

3P

4P

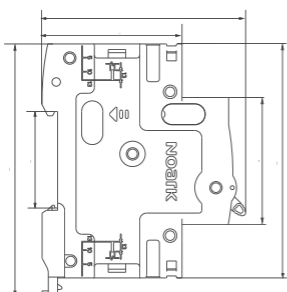

1P

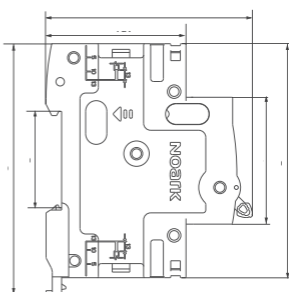

2P-4P

Ex9IP光伏隔离开关 Ex9IP Series DC Switch Disconnecter

安装步骤 Installation

3

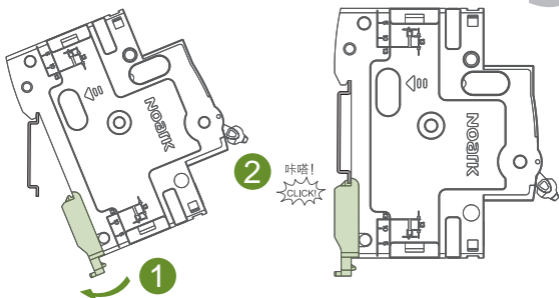

Ex9IP光伏隔离开关 Ex9IP Series DC Switch Disconnecter

拆卸步骤 Removal

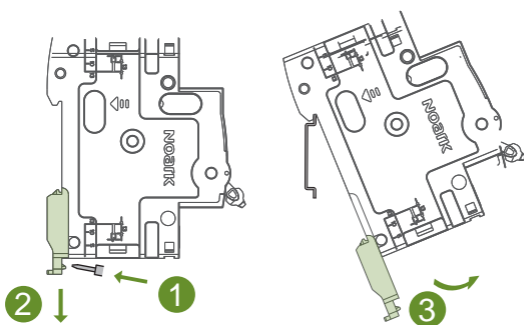

4



Ex9IP光伏隔离开关 Ex9IP Series DC Switch Disconnecter

接线 Wiring

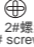
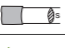
5

接线工具 Connection tool		 2#螺丝刀 2# screw driver
接线能力(mm ²) Wiring capability		In 32A, 1-25mm ² In 40A, 10-35mm ²
拧紧力矩(Nm) Tightening torque		3.5Nm

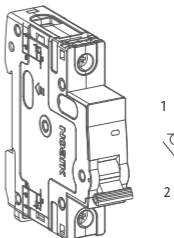

1P : 250VDC

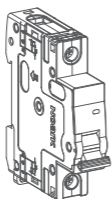

1P

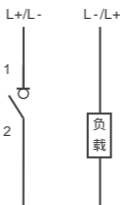

2P : 500VDC

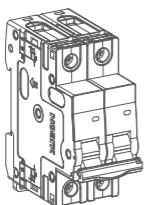

2P

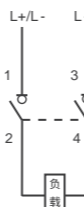

不接地系统

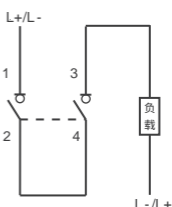

单极接地系统

3P : 750VDC

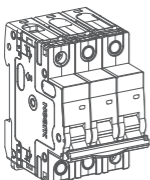

3P

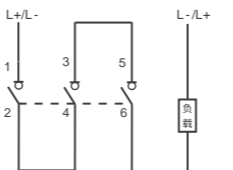

单极接地系统

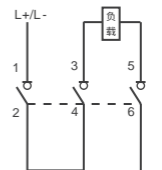

不接地系统

4P : 1000VDC

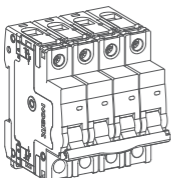

4P

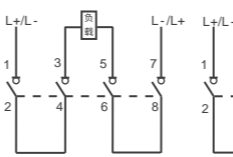

不接地系统

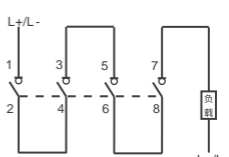

单极接地系统

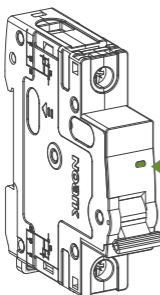

绿色指示
Green

断开
OFF

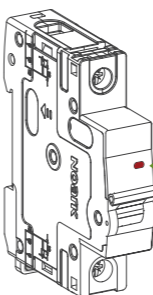

红色指示
Red

闭合
ON

上海诺雅克电气有限公司

NOARK Electric (Shanghai) Co., Ltd.

地址：上海市松江区文合路855号

Add : 855 Wenhe Road, Songjiang District, Shanghai

电话：+86-21-3779 1111

Tel : +86-21-3779 1111



采用环保纸印刷

Printed with environment-friendly paper

本说明书解释权归NOARK所有。

The expression right of the instructions are owned by NOARK.

客服热线 / Customer Service Hotline:



400-1092-111

Zb0301201101CE